



**LOCAL EXPERTS.
INDUSTRIAL STRENGTH.**

**1,540 SF Office Space
FOR LEASE**

**2305 S. Syracuse Way
Denver, CO 80231**



**1,540 SF | UNIT 10
MONTHLY RENT: \$1,950.00**

Located on the south side of Evans Avenue just east of Quebec Street, 2305 S Syracuse Way is a functional, high-image, flex property that is only minutes from I-25 and I-225. There's currently one unit available at 1,540 square feet.

PROPERTY FEATURES:

Gross Building SF: 21,327

Available Unit Size: 1,540 SF

Site Size: 1.57 AC

Year Built: 1982

Parking: On-site and street

Zoning: B-4

Base Rent: \$9.00/SF

Expenses: \$6.20/SF (2023)

Monthly MG Rent: \$1,950.00



© 2023 Ringsby Realty Corp. All rights reserved. This information has been obtained from sources believed reliable, but has not been verified for accuracy or completeness. You should conduct a careful, independent investigation of the property and verify all information. Any reliance on this information is solely at your own risk. Ringsby Realty Corp. and the Ringsby Realty Corp. logo are service marks of Ringsby Realty Corp. All other marks displayed on this document are the property of their respective owners, and the use of such logos does not imply any affiliation with or endorsement of Ringsby Realty Corp. Photos herein are the property of their respective owners. Use of these images without the express written consent of the owner is prohibited.



**LOCAL EXPERTS.
INDUSTRIAL STRENGTH.**

**1,540 SF Office Space
FOR LEASE**

**2305 S. Syracuse Way
Denver, CO 80231**

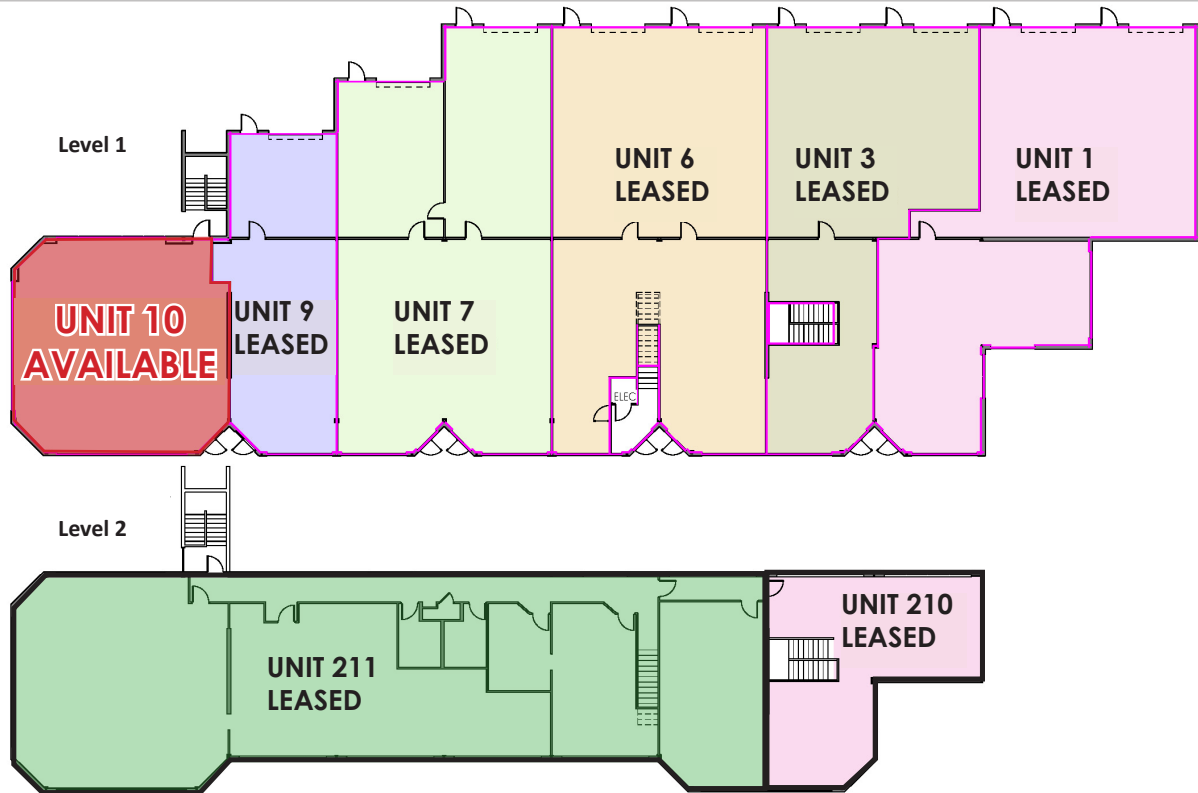

UNIT	TOTAL SF	APPROX. OFFICE SF	APPROX. WAREHOUSE SF	DRIVE-IN DOORS	MONTHLY MG RENT
10	1,540	100%	0%	0	\$1,950



LOCAL EXPERTS. INDUSTRIAL STRENGTH.

1801 W Colfax Ave.
Denver, CO 80204
www.ringsbyrealty.com

Brian Wilkes

brian@ringsbyrealty.com
(303) 892-0112